



BATH SHOWROOM LOCATIONS:

Ballston Spa 518.885.5311	Perth 518.883.9663
Queensbury 518.792.8601	Norwich 518.337.9322
Schuylerville 518.695.3242	Hamilton 315.824.2233
Hoosick 518.686.7391	Richmondville 518.519.2001
Granville 518.642.2855	Plattsburgh 518.561.2691
Delmar 518.439.9968	Ray Brook 518.891.2216
East Greenbush 518.477.7503	Burlington, VT 802.863.3428

We Also Have Store Locations In...

Fort Plain 518.993-5755	Schaghticoke 518.753.4266	Schroon Lake 518-532-7404
Warrensburg 518.623.3281	Sidney 607-335-4170	Delhi 607.746.2386
Waterville 315.841.4111	New Berlin 607.847.6101	Williston, VT 802.863.3428

CurtisLumber.com



facebook.com/curtislumber



instagram.com/curtislumberco



houzz.com/pro/curtislumber18



youtube.com/curtislumbercompany

TYPES OF VANITIES



FLOATING/WALL MOUNTED

- Does not touch floor
- Clean/contemporary look
- Plumbing must be through wall
- Secured to studs which may need to be reframed to accommodate brackets



I WANT THIS!
(skip to page 10)



FURNITURE STYLE

- Touches floor with legs of some type, but open underneath
- Appears as a furniture piece
- Plumbing must be through wall
- Secured to studs



I WANT THIS!



CONSOLE STYLE

- Touches floor with legs, and usually has a shelf underneath
- Appears as a furniture piece
- Lends itself to an open concept due to its compact size
- Plumbing must be through wall



I WANT THIS!
(skip to page 7)



FREESTANDING

- Most common style
- Multiple cabinets can be combined to create custom sizes/configurations
- Plumbing can be through wall or floor
- Secured to studs, also rests on floor with closed toe-kick
- Ability to achieve furniture look by adding field installed legs/valance pieces



I WANT THIS!

STANDARD FREESTANDING VANITY

SIZES AND CONFIGURATIONS

This depicts standard vanity sizes and configurations which may not be available across all five of our lines.

Other sizes/configurations may be available within different cabinet lines. Vanities are built in increments of 3" and may either be 18" or 21" deep, and 31 1/2" or 34 1/2" high. Pieces of wood called "fillers" are used to fill in spaces that standard sizes cannot accommodate and to allow for wall and/or door clearances. Most freestanding vanities can be turned into furniture style by voiding the toe kick and adding legs.

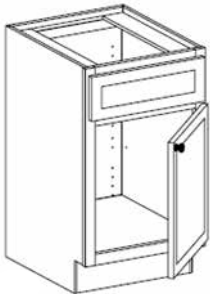

OPTION F1

18" or 21" wide

One Door hinged left or right
(right shown)

No Drawers

☐

I WANT THIS, AND MY SIZE IS:

WIDTH: _____ DEPTH: _____ HEIGHT: _____

DOOR HINGE DIRECTION: _____

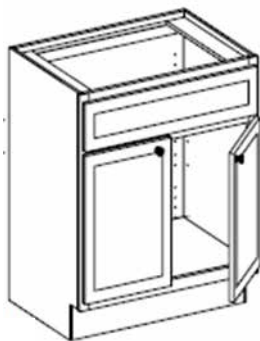

OPTION F2

24", 27", 30", 33" or 36" wide

Two Doors

No Drawers

☐

I WANT THIS, AND MY SIZE IS:

WIDTH: _____ DEPTH: _____ HEIGHT: _____

DOOR HINGE DIRECTION: _____

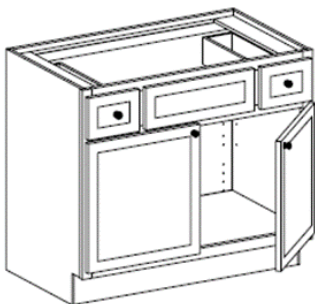

OPTION F3

36" wide

Two Doors

Two Drawers

☐

I WANT THIS, AND MY SIZE IS:

WIDTH: **36"** DEPTH: _____ HEIGHT: _____

DOOR HINGE DIRECTION: _____



OPTION F4

42" or 45" wide

Three Doors

Center door hinged
left or right (left shown)

Two Drawers

☐

I WANT THIS, AND MY SIZE IS:

WIDTH: _____ DEPTH: _____ HEIGHT: _____

DOOR HINGE DIRECTION: _____

STANDARD FREESTANDING VANITY

SIZES AND CONFIGURATIONS

This depicts standard vanity sizes and configurations which may not be available across all five of our lines.

Other sizes/configurations may be available within different cabinet lines. Vanities are built in increments of 3" and may either be 18" or 21" deep, and 31 ½" or 34 ½" high. Pieces of wood called "fillers" are used to fill in spaces that standard sizes cannot accommodate and to allow for wall and/or door clearances. Most freestanding vanities can be turned into furniture style by voiding the toe kick and adding legs.



OPTION F5

24", 27", 30", 33, 36" or 39" wide

One Door hinged left or right
(left shown)

Two Drawers left or right

☐

I WANT THIS, AND MY SIZE IS:

WIDTH: _____ DEPTH: _____ HEIGHT: _____

DOOR HINGE DIRECTION: _____



OPTION F6

24", 27", 30", 33", 36" or 39" wide

One Door hinged left or right
(left shown)

Two Drawers left or right

☐

I WANT THIS, AND MY SIZE IS:

WIDTH: _____ DEPTH: _____ HEIGHT: **34 ½"**

DOOR HINGE DIRECTION: _____

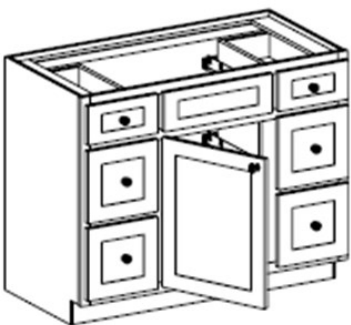

OPTION F7

42" or 45" wide

One Door hinged left or right
(left shown)

Six Drawers

☐

I WANT THIS, AND MY SIZE IS:

WIDTH: _____ DEPTH: _____ HEIGHT: **34 ½"**

DOOR HINGE DIRECTION: _____

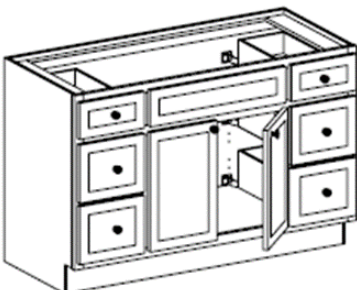

OPTION F8

48", 51", 54", 57" or 60" wide

Two Doors

Six Drawers

☐

I WANT THIS, AND MY SIZE IS:

WIDTH: _____ DEPTH: _____ HEIGHT: _____

DOOR HINGE DIRECTION: _____

STANDARD FREESTANDING VANITY

SIZES AND CONFIGURATIONS

This depicts standard vanity sizes and configurations which may not be available across all five of our lines.

Other sizes/configurations may be available within different cabinet lines. Vanities are built in increments of 3" and may either be 18" or 21" deep, and 31 ½" or 34 ½" high. Pieces of wood called "fillers" are used to fill in spaces that standard sizes cannot accommodate and to allow for wall and/or door clearances. Most freestanding vanities can be turned into furniture style by voiding the toe kick and adding legs.



OPTION F9

42" or 45" wide

One Door hinged left or right
(right shown)

Eight Drawers

☐

I WANT THIS, AND MY SIZE IS:

WIDTH: _____ DEPTH: _____ HEIGHT: **34 ½"**

DOOR HINGE DIRECTION: _____



OPTION F10

48", 51", 54", 57" or 60" wide

Two Doors

Eight Drawers

☐

I WANT THIS, AND MY SIZE IS:

WIDTH: _____ DEPTH: _____ HEIGHT: **34 ½"**

DOOR HINGE DIRECTION: _____

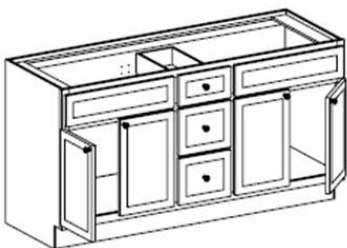

OPTION F11

60", 66" or 72" wide

Ideal for double bowl vanity tops

Two sets double doors

Three Drawers

☐

I WANT THIS, AND MY SIZE IS:

WIDTH: **60"** DEPTH: _____ HEIGHT: _____

DOOR HINGE DIRECTION: _____

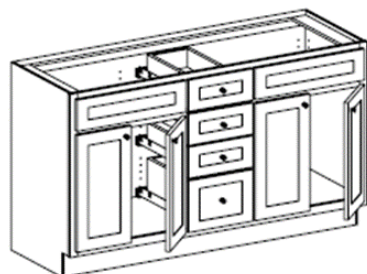

OPTION F12

60" wide

Ideal for double bowl vanity tops

Two sets double doors

Four Drawers

☐

I WANT THIS, AND MY SIZE IS:

WIDTH: **60"** DEPTH: _____ HEIGHT: **34 ½"**

DOOR HINGE DIRECTION: _____

FURNITURE STYLE FEET

Transform A Freestanding Vanity Into A Furniture Style Vanity By Adding Feet!

Please make sure your plumbing is through the wall!

These are just some examples of foot options and may not be available across all our lines.

Please circle the foot option(s) you like best:

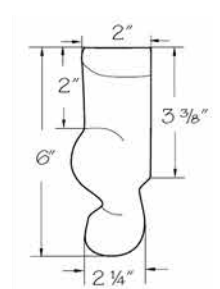
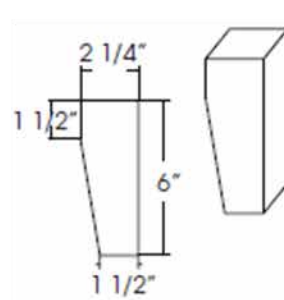
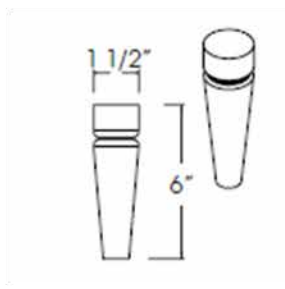
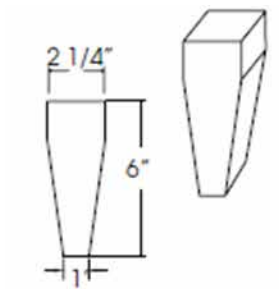
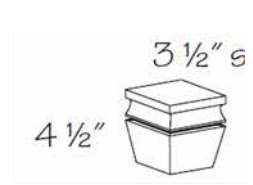
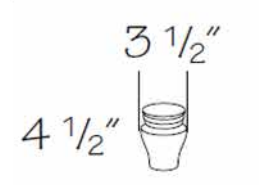
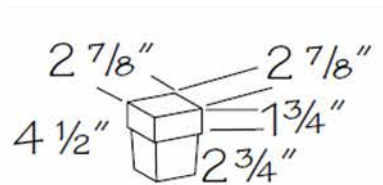
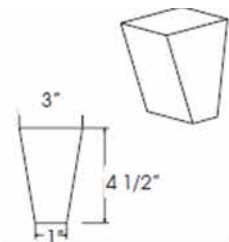
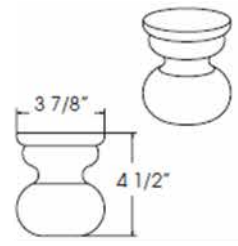
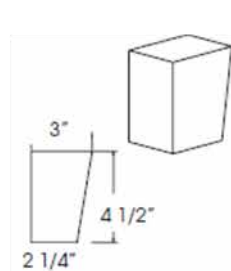
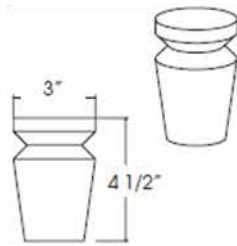

CONSOLE VANITY

SIZES & CONFIGURATIONS

This depicts standard vanity sizes and configurations which may not be available across all five of our lines.

Other sizes/configurations may be available within different cabinet lines. Vanities are built in increments of 3" and may either be 18" or 21" deep.

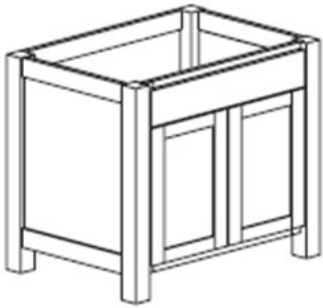

OPTION C1

24", 27", 30", 33" or 36" wide

Two Doors

No Drawers

☐

I WANT THIS, AND MY SIZE IS:

WIDTH: _____ DEPTH: _____ HEIGHT: **34 ½"**

DOOR HINGE DIRECTION: _____

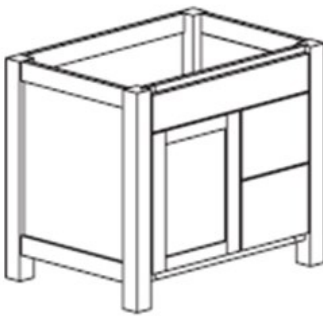

OPTION C2

24", 27", 30", 33" or 36" wide

One Door hinged left or right

Two Drawers left or right

☐

I WANT THIS, AND MY SIZE IS:

WIDTH: _____ DEPTH: _____ HEIGHT: **34 ½"**

DOOR HINGE DIRECTION: _____

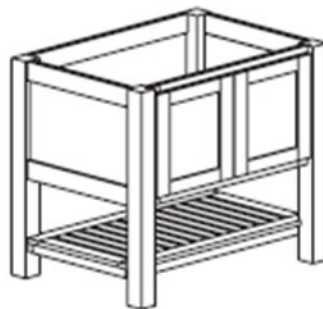

OPTION C3

24", 27", 30", 33", 36" or 39" wide

Two Doors

No Drawers

☐

I WANT THIS, AND MY SIZE IS:

WIDTH: _____ DEPTH: _____ HEIGHT: **34 ½"**

DOOR HINGE DIRECTION: _____

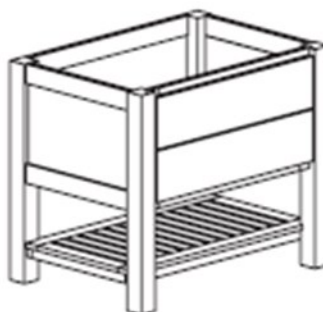

OPTION C4

24", 27", 30", 33", 36" or 39" wide

One U-shaped Drawer

☐

I WANT THIS, AND MY SIZE IS:

WIDTH: _____ DEPTH: _____ HEIGHT: **34 ½"**

DOOR HINGE DIRECTION: _____

CONSOLE VANITY

SIZES & CONFIGURATIONS

This depicts standard vanity sizes and configurations which may not be available across all five of our lines.

Other sizes/configurations may be available within different cabinet lines. Vanities are built in increments of 3" and may either be 18" or 21" deep.

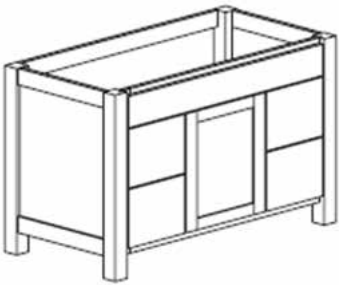

OPTION C5

42" wide

One Door hinged left or right
Four Drawers

☐

I WANT THIS, AND MY SIZE IS:

WIDTH: _____ DEPTH: _____ HEIGHT: **34 ½"**

DOOR HINGE DIRECTION: _____

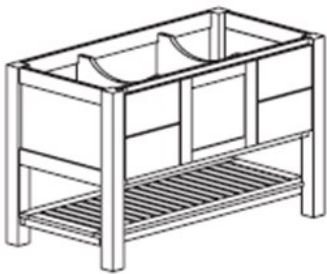

OPTION C6

42" wide

One Door hinged left or right
Four Drawers left or right

☐

I WANT THIS, AND MY SIZE IS:

WIDTH: **42"** DEPTH: _____ HEIGHT: **34 ½"**

DOOR HINGE DIRECTION: _____

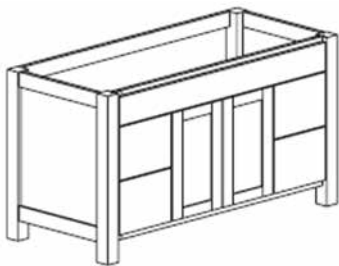

OPTION C7

45", 48", 54", 60", 66" or 72" wide

Two Doors
Four Drawers

☐

I WANT THIS, AND MY SIZE IS:

WIDTH: _____ DEPTH: _____ HEIGHT: **34 ½"**

DOOR HINGE DIRECTION: _____

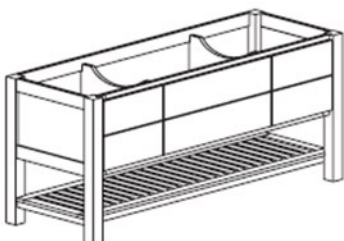

OPTION C8

42", 45", 48", 54", 60", 66" or 72" wide

One U-shaped Drawer center
Four Drawers

☐

I WANT THIS, AND MY SIZE IS:

WIDTH: _____ DEPTH: _____ HEIGHT: **34 ½"**

DOOR HINGE DIRECTION: _____

CONSOLE VANITY

SIZES & CONFIGURATIONS

This depicts standard vanity sizes and configurations which may not be available across all five of our lines.

Other sizes/configurations may be available within different cabinet lines. Vanities are built in increments of 3" and may either be 18" or 21" deep.

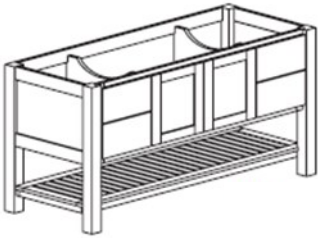

OPTION C9

45", 48", 54", 60", 66" or 70" wide

Two Doors

Four Drawers

☐

I WANT THIS, AND MY SIZE IS:

WIDTH: _____ DEPTH: _____ HEIGHT: **34 ½"**

DOOR HINGE DIRECTION: _____

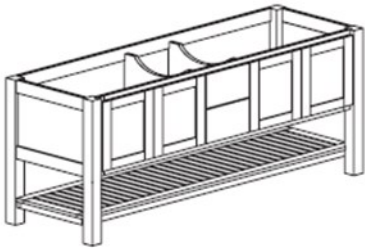

OPTION C10

60", 66" or 72" wide

Ideal for double bowl vanity tops

Two Drawers centered

Four Doors

☐

I WANT THIS, AND MY SIZE IS:

WIDTH: _____ DEPTH: _____ HEIGHT: **34 ½"**

DOOR HINGE DIRECTION: _____

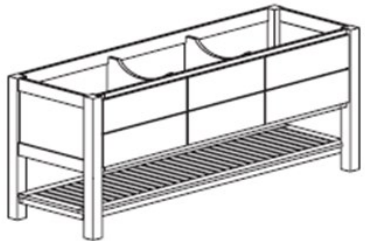

OPTION C11

66" or 72" wide

Ideal for double bowl vanity tops

Two Drawers centered

Two U-Shaped Drawers

☐

I WANT THIS, AND MY SIZE IS:

WIDTH: _____ DEPTH: _____ HEIGHT: **34 ½"**

DOOR HINGE DIRECTION: _____

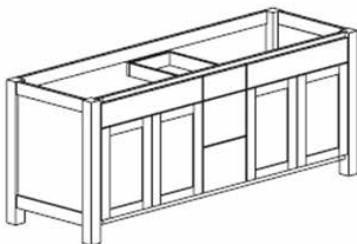

OPTION C12

66" or 72" wide

Ideal for double bowl vanity tops

Three Drawers centered

Four Doors

☐

I WANT THIS, AND MY SIZE IS:

WIDTH: _____ DEPTH: _____ HEIGHT: **34 ½"**

DOOR HINGE DIRECTION: _____

FLOATING/WALL MOUNTED VANITY SIZES AND CONFIGURATIONS

This depicts standard vanity sizes and configurations which may not be available across all five of our lines.

Other sizes/configurations may be available within different cabinet lines. Vanities are built in increments of 3" and may either be 18" or 21" deep.

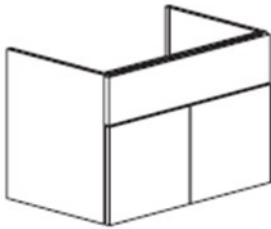

OPTION WM1

24", 27", 30", 33" or 36" wide

Two Doors with blank or full height

☐

I WANT THIS, AND MY SIZE IS:

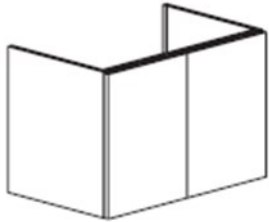

WIDTH: _____ DEPTH: _____ HEIGHT: 19 7/8"

DOOR HINGE DIRECTION: _____

YOU CAN ADD DOOR OR DRAWER MODULES AS FOLLOWS:

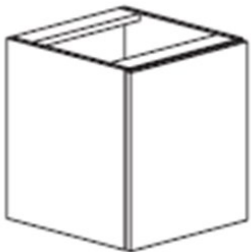

OPTION WM2

12", 15", 18", or 24" wide

One door hinged left or right

☐

I WANT THIS, AND MY SIZE IS:

WIDTH: _____ DEPTH: _____ HEIGHT: 19 7/8"

DOOR HINGE DIRECTION: _____

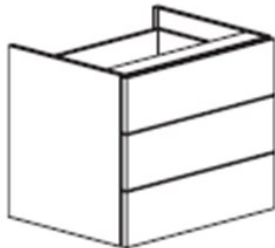

OPTION WM3

12", 15", 18", or 24" wide

Two or three drawers

☐

I WANT THIS, AND MY SIZE IS:

WIDTH: _____ DEPTH: _____ HEIGHT: 19 7/8"

DOOR HINGE DIRECTION: _____

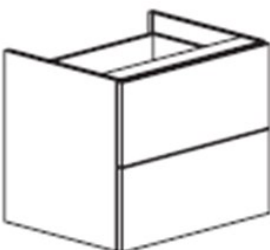

CABINET BRANDS

\$\$\$

MERILLAT CLASSIC



MERILLAT CABINETRY

Offers 26 door styles, 6 paints, 10 stains

Standard: 3/8" furniture board sides, 1/4" furniture board backs, 1/2" furniture board bottom, 3/4" furniture board shelves

Upgrade: 1/2" plywood sides, 1/4" plywood back, 1/2" plywood bottom, 3/4" plywood shelves, dovetail, soft-close

\$\$\$

BERTCH BATH



Offers 28 door styles, 9 paints, 13 stains
(Console Style only available in Interlude door style)

Standard: 1/2" furniture board sides, 1/8" "material" backs, 1/2" furniture board bottom, 1/2" furniture board shelves

Upgrade: 3/4" plywood sides, 1/8" plywood back, 1/2" furniture board bottom, 1/2" furniture board shelves, dovetail, soft-close

\$\$\$

WELLBORN PREMIER (ELEGANT BATH COLLECTION)



Offers 52 door styles, 16 paints, 24 stains

Standard: 1/2" furniture board unfinished sides, 1/8" MDF backs, 1/2" furniture board bottom, 3/4" furniture board shelves

Upgrade: 1/2" plywood sides, 3/16" plywood back, 1/2" plywood bottom, 3/4" plywood shelves, dovetail, soft-close

CABINET BRANDS

\$\$\$

MERILLAT MASTERPIECE



MERILLAT CABINETRY

Offers 47 door styles, 15 paints, 19 stains

Standard: 1/2" furniture board sides, 3/8" furniture board backs,
1/2" furniture board bottom, 3/4" furniture board shelves

Upgrade: 3/4" plywood sides, 3/8" plywood backs,
1/2" plywood bottom, 3/4" plywood shelves, dovetail, soft-close

\$\$\$

CRYSTAL KEYLINE



Offers 46 door styles, 14 paints, 28 stains

Standard: 1/2" plywood unfinished sides, 1/2" plywood backs,
1/2" plywood bottom, 3/4" plywood shelves, dovetail, soft-close

Upgrade: 3/4" flush plywood sides, 1/2" plywood backs,
1/2" plywood bottom, 3/4" plywood shelves, dovetail, soft-close

VANITY CABINET SELECTIONS

It is **not** mandatory that you fill this out on your own.

We are happy to assist you! Thank you for your valued business.

Brand: _____

Door Style: _____

Wood Species: _____

Standard Configuration Option #: _____

Size: _____"W x _____"D x _____"H

Door Hinge: ☐ Right ☐ Left

Drawers: # _____ ☐ Right ☐ Left

Construction: ☐ Standard ☐ Upgraded
(SOFT CLOSE)

MY LAYOUT

Please draw in wall locations where applicable, and locate where vanity will be installed.

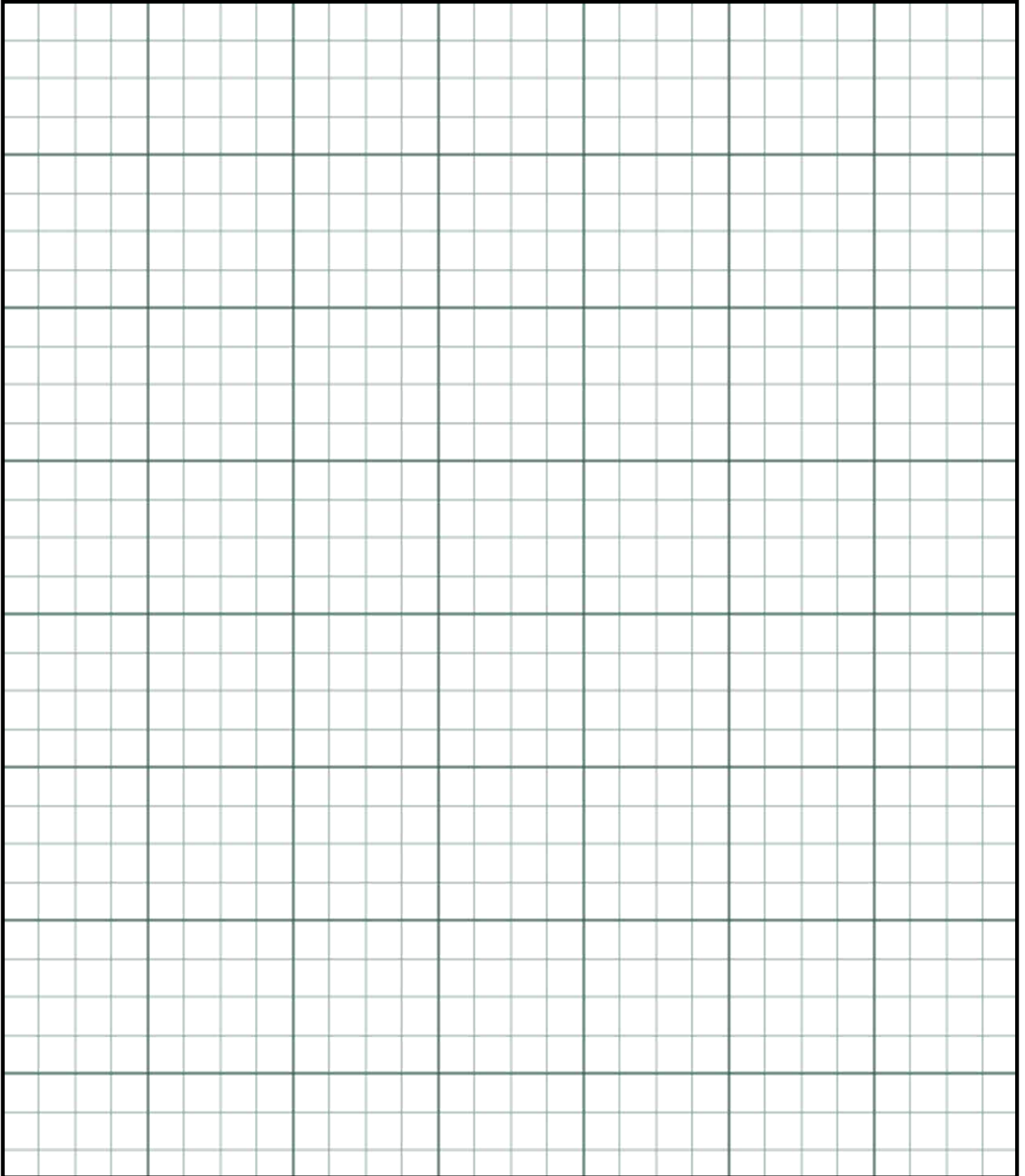

COUNTERTOP OPTIONS

\$\$\$

BERTCH OASIS CULTURED MARBLE



Integrated sink and optional backsplash/side splashes

Offers 40 colors, 3 edge profiles, 6 bowl shapes

4 week lead time make and deliver ONLY



Other cultured marble vanity top options available.



I WANT THIS!

\$\$\$

WOLF GRANITE



Undermount porcelain sink and loose backsplash/side splashes

Offers 12 colors, 5 edge profiles, 3 bowl shapes

4 week lead time make and deliver ONLY



Other cultured marble vanity top options available.



I WANT THIS!

COUNTERTOP OPTIONS

\$\$\$

CAMBRIA QUARTZ

Undermount porcelain sink and optional backsplash/side splashes

Offers 201 colors, 11 edge profiles, 4 bowl shapes

3-4 week lead time make and deliver

4-8 week lead time for template and install



C A M B R I A®



I WANT THIS!

\$\$\$

CORIAN SOLID SURFACE

Integrated solid surface sink (in select colors) and optional loose backsplash/side splashes

Offers 104 colors, 7 edge profiles, 11 bowl shapes

4-8 week lead time for template and install ONLY



I WANT THIS!

VANITY TOP SELECTIONS

It is **not** mandatory that you fill this out on your own.
We are happy to assist you! Thank you for your valued business.

Material: _____

Design: _____

Bowl Shape & Color: _____

Edge Profile: _____

Back/Sidesplash: _____

Faucet Drilling: _____

Indicate Faucet Hole Placement and “X” For Finished Edges:

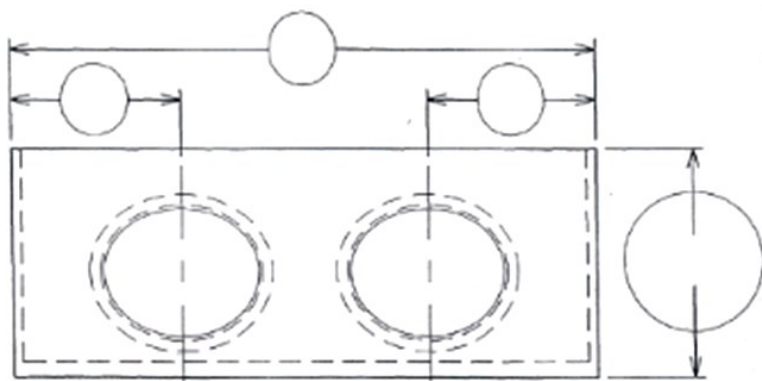

Double Bowl Vanity

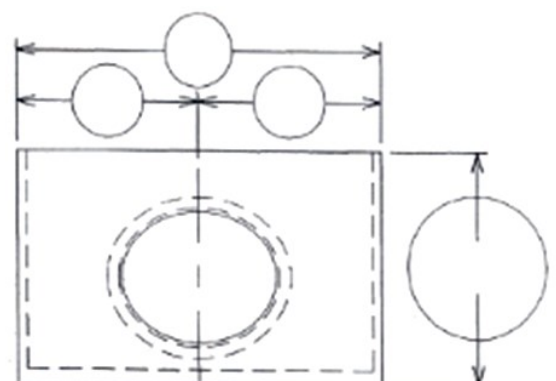

Single Bowl Vanity

NOTES

[illegible]