

About Curtis Lumber

We are a family-owned and operated company that has been serving our local communities in New York and Vermont since 1890.

Whether you're a contractor or homeowner, Curtis Lumber has experience in serving you!

Ballston Spa
518-885-5311

Perth
518-883-9663

Queensbury
518-792-8601

Norwich
607-337-9322

Schroon Lake
518-532-7404

Delhi
607-746-2386

Granville
518-642-2855

New Berlin
607-847-6101

Warrensburg
518-623-3281

Waterville
315-841-4111

East Greenbush
518-477-7503

Hamilton
315-824-2233

Fort Plain
518-993-5755

Ray Brook
518-891-2216

Schuylerville
518-695-3242

Richmondville
518-519-2001

Delmar
518-439-9968

Plattsburgh
518-561-2691

Hoosick
518-686-7391

Burlington, VT
802-651-6500

Visit Us Online
CurtisLumber.com

WEEKEND PROJECT

Garden Bed Plans



PREP

- Measure all lengths twice before cutting. (see cut sheet).

MATERIALS

SOUTHERN YELLOW PINE

3	2"x12" SYP boards (#S2128)	8'
1	4"x4" KD Doug Fir post (#A48WP)	8'

HARDWARE

1	lb. box 3" tan deck screws (#NP3STT1)
2	rolls of hardware cloth (#6100234)
(Optional)	1 pint tung oil finish (#3487964)
Staples for staple gun	

TOOLS

- Drill
- Impact Driver (optional)
- Saw
- Staple Gun
- Measuring Tape
- Pre-Drill Bit (3/32") +/-
- Pencil
- Square
- Protective Clothing
- Protective Eyewear



1. DETERMINE WHERE TO PLACE YOUR GARDEN BED.

- Find a location in your yard with a good source of sunlight and is as level as possible.
- Another thing to consider when selecting a location is how easily it can be reached by a hose, drip or sprinkler system.
- Find an area that is free of rocks and on soil.

2. MEASURE AND CUT YOUR PIECES OF LUMBER.

- Using a tape measure, measure out the following lengths and mark the cut locations with a pencil:
- Two 2 x 12 boards, each 8 feet long (Side Pieces)
- Two 2 x 12 boards, each 4 feet long (End Pieces)
- Four 4 x 4 pieces, each 11 1/2" long (Corner Reinforcements)
- Cut to length using your saw

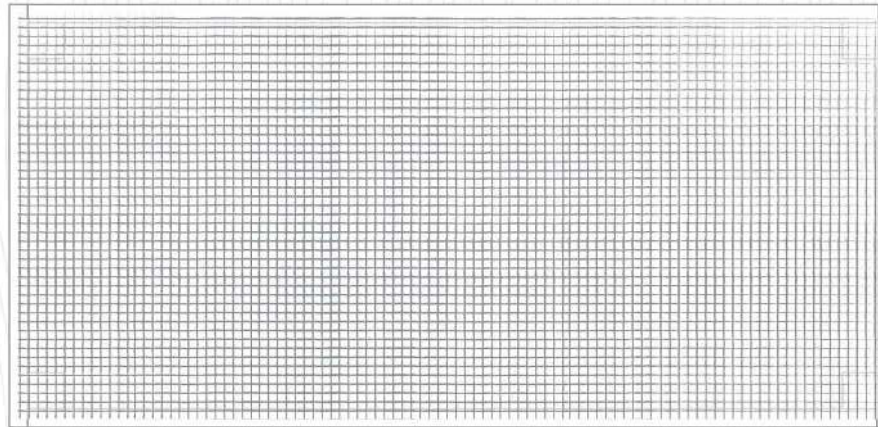
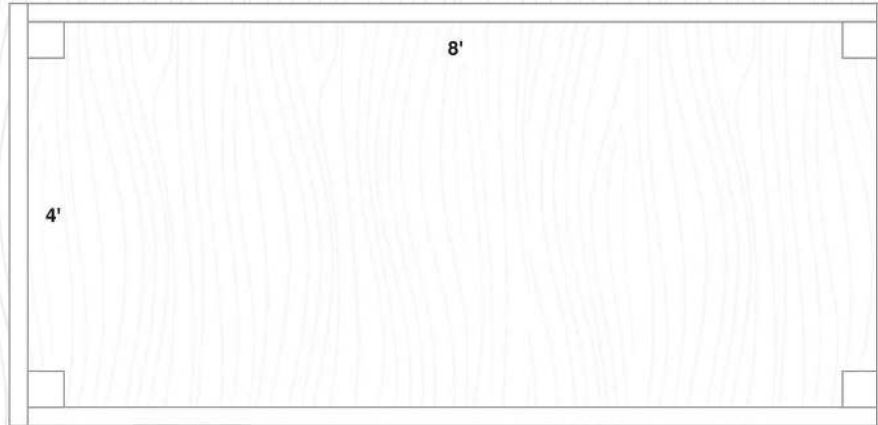
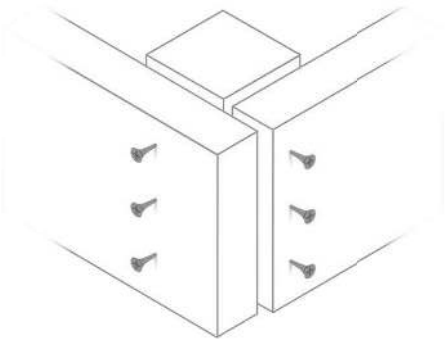

3. ASSEMBLE THE GARDEN BEDS.

- Take one side piece, one end piece and a corner reinforcement and line them up how they would look in the garden bed.
- Pre-Drill the three holes on your boards where you will place screws (one about two inches from the top, one about six inches from the top and one two inches from the bottom) using your drill bit.
- Line up the pieces together to form a corner.
- Using a drill or impact driver, tack the pieces together.
- Measure using your square to make sure the side is square.
- Once it is determined that it is square drive the screw in the rest of the way to fasten.
- Repeat the steps above to assemble all four sides of the garden bed.
- If there are knot holes or cracks, cover them up with gopher wire or hardware cloth so a gopher can't climb in.

4. ATTACH HARDWARE CLOTH OR GOPHER WIRE.

- Flip the garden bed so it is bottom side up.
- Cut the gopher wire or hardware cloth so it is the same length/width of your garden bed (you may have to do two rows of this material, if so, make sure there is overlap).
- Attach to the bottom of the bed using a staple gun and galvanized staples.

5. GARDEN BED USE.

- Flip the garden bed over so the Gopher Wire or Hardware Cloth is at the bottom of the bed.
- Optional - To protect your new garden bed for years to come, finish with tung oil and allow to dry.
- Fill the bed up with soil and plant your garden!



ENJOY! | ALWAYS WEAR PROTECTIVE GEAR! | **SAFETY FIRST!**